



TURNBUCKLE BODIES / STUB END TURNBUCKLES

CAUTION: NEVER EXCEED THE WORKING LOAD LIMIT.

Read important warnings and information in T.O.C. > GENERAL WARNINGS and TURNBUCKLES ⚠️.

Meets the performance requirements of ASTM F 1145. Self-colored finish. Some bodies available hot-galvanized. Drop forged.

Size Diameter (A) x Take-Up (B)	Working Load Limit in Pounds	Approximate Weight Each Body Only in Pounds	Approximate Weight Each Stub End in Pounds	Dimensions in Inches			
				C	D	E	F*
3/8" x 6"	1,200	.3	.7	7.13	.56	4.44	16.00
1/2" x 6"	2,200	.6	1.4	7.50	.75	4.25	16.00
1/2" x 9"	2,200	.8	1.7	10.50	.75	4.25	19.00
1/2" x 12"	2,200	1.0	1.8	13.50	.75	4.25	22.00
5/8" x 6"	3,500	1.0	2.0	7.88	.94	4.06	16.00
5/8" x 9"	3,500	1.2	2.5	10.88	.94	4.06	19.00
5/8" x 12"	3,500	1.4	3.1	13.88	.94	4.06	22.00
3/4" x 6"	5,200	1.2	3.3	8.25	1.13	4.38	17.00
3/4" x 9"	5,200	1.6	4.0	11.25	1.13	4.38	20.00
3/4" x 12"	5,200	2.1	4.8	14.25	1.13	4.38	23.00
3/4" x 18"	5,200	3.2	5.8	20.25	1.13	4.38	29.00
7/8" x 6"	7,200	1.8	4.5	8.63	1.31	4.69	18.00
7/8" x 12"	7,200	2.7	6.4	14.63	1.31	4.69	24.00
7/8" x 18"	7,200	3.8	---	20.63	1.31	---	---
1" x 6"	10,000	2.5	6.3	9.00	1.50	5.00	19.00
1" x 12"	10,000	4.2	8.9	15.00	1.50	5.00	25.00
1" x 18"	10,000	7.0	11.4	21.00	1.50	5.00	31.00
1" x 24"	10,000	7.4	---	27.00	1.50	---	---
1.1/8" x 6"	12,400	5.0	---	9.13	1.56	---	---
1.1/8" x 12"	12,400	5.4	---	15.13	1.56	---	---
1.1/4" x 6"	15,200	5.0	10.2	9.13	1.56	5.44	20.00
1.1/4" x 12"	15,200	5.4	13.6	15.13	1.56	5.44	26.00
1.1/4" x 18"	15,200	8.0	---	21.10	1.56	---	---
1.1/4" x 24"	15,200	10.2	---	27.13	1.56	---	---
1.3/8" x 6"	18,000	6.0	13.9	9.75	1.88	5.38	20.50
1.1/2" x 6"	21,400	5.7	15.1	9.75	1.88	5.38	20.50
1.1/2" x 12"	21,400	8.5	20.5	15.75	1.88	5.38	26.50
1.1/2" x 18"	21,400	11.0	---	21.75	1.88	---	---
1.1/2" x 24"	21,400	13.7	---	27.75	1.88	---	---
1.5/8" x 6"	25,000	8.2	---	10.38	2.19	---	---
1.3/4" x 6"	28,000	10.3	22.5	10.38	2.19	5.80	22.00
2" x 6"	37,000	14.2	34.0	11.00	2.50	6.00	23.00
2" x 24"	37,000	30	---	29.00	2.50	---	---
2.1/2" x 6"	60,000	33	68.0	13.50	3.75	6.25	26.00
2.1/2" x 12"	60,000	46	---	19.50	3.75	---	---
2.1/2" x 24"	60,000	59	---	31.50	3.75	---	---
2.3/4" x 24"	75,000	59	---	31.50	3.75	---	---

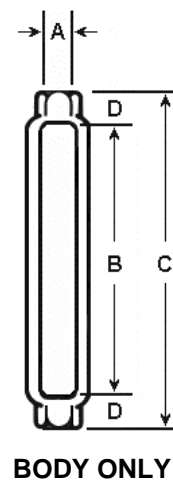
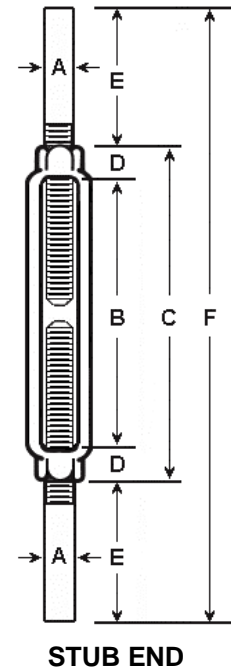

* Closed position