



THIMBLES

Read important warnings and information in T.O.C. > GENERAL WARNINGS and THIMBLES ⚠️.

GALVANIZED HEAVY DUTY WIRE ROPE THIMBLES

Hot dip galvanized. Meets the performance requirements of Federal Specification FF-T-276b, Type III.

Size	Approx. Weight Each in Pounds	Dimensions in Inches				
		A	B	C	D	E
1/4"	.075	2.19	1.50	1.63	.88	.41
5/16"	.14	2.50	1.81	1.88	1.06	.50
3/8"	.25	2.88	2.13	2.13	1.13	.66
7/16"	.36	3.25	2.25	2.38	1.25	.75
1/2"-9/16"	.51	3.63	2.56	2.75	1.50	.84
5/8"	.75	4.25	3.00	3.25	1.75	1.00
3/4"	1.47	5.00	3.50	3.75	2.00	1.25
7/8"	1.85	5.50	4.00	4.25	2.25	1.38
1"	3.00	6.13	4.38	4.50	2.50	1.56
1.1/8"-1.1/4"	3.80	7.00	5.63	5.13	2.88	1.88
1.1/4"-1.3/8"	8.60	9.06	6.75	6.50	3.50	2.25
1.3/8"-1.1/2"	11.00	9.06	7.00	6.50	3.50	2.63
1.5/8"	11.80	11.25	8.13	8.00	4.00	2.72
1.3/4"	17.90	12.19	8.25	9.00	4.50	2.88
1.7/8"-2"	25.00	15.13	10.25	12.00	6.00	3.13
2.1/4"	45.00	17.13	11.88	14.00	7.00	3.63
2.1/2" *	63.50	22.25	12.75	17.50	8.00	4.38

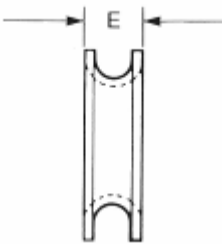
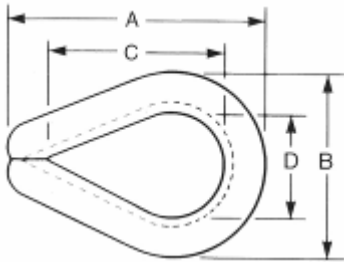

*2.1/2" available with or without gusset plates.

STAINLESS HEAVY DUTY WIRE ROPE THIMBLES

TYPE 304 and 316.

Size	Approx. Weight Each in Pounds	Dimensions in Inches				
		A	B	C	D	E
1/8" **	.02	1.88	1.06	1.25	.69	.16
3/16"	.023	1.79	1.30	1.30	.76	.21
1/4"	.08	2.19	1.50	1.63	.88	.44
5/16"	.10	2.50	1.88	1.88	1.13	.50
3/8"	.25	2.88	2.09	2.12	1.13	.66
1/2"	.45	3.63	2.63	2.75	1.50	.88
5/8"	.68	4.25	3.09	3.25	1.75	1.00
3/4"	1.20	5.00	3.50	3.75	2.00	1.25
7/8"	1.85	5.66	4.19	4.31	2.25	1.50
1"	2.20	6.13	4.63	5.00	2.50	1.56
1.1/8"-1.1/4"	3.80	7.13	5.33	5.38	2.88	1.88
1.1/4"-1.3/8"	8.60	8.38	6.67	6.50	3.50	2.25

**1/8" available in REGULAR style and TYPE 304 only.