

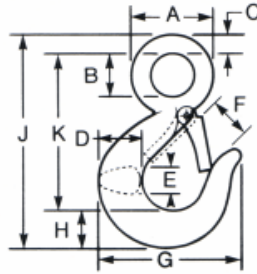

# EYE HOOKS

**CAUTION: NEVER EXCEED THE WORKING LOAD LIMIT.**

Read important warnings and information in T.O.C. > GENERAL WARNINGS and HOOKS ⚠️.



Carbon or Alloy steel, forged, heat-treated, painted, with latch installed or without.

Some sizes also available in DOMESTIC

Size (WLL)*		Dimensions in inches										Approximate Weight Each with Latch in Pounds
Carbon	Alloy	A	B	C	D	E	F	G	H	J	K	
**3/4 Ton	1 Ton	1.50	.75	.38	.88	.63	.94	2.88	.75	4.38	3.25	.6
**1	1.1/2	1.75	.88	.44	1.00	.69	1.06	3.13	.81	4.88	3.63	.82
**1.1/2	2	2.00	1.13	.44	1.19	.81	1.06	3.50	1.00	5.50	4.13	1.44
2	3	2.38	1.25	.59	1.38	.94	1.22	3.94	1.19	6.31	4.56	1.94
3	5	3.00	1.56	.69	1.63	1.19	1.50	5.00	1.50	7.94	5.75	3.94
5	7	3.81	2.00	.88	2.06	1.50	1.88	6.25	1.75	10.00	7.38	7.75
7.1/2	11	4.69	2.44	1.13	2.63	1.63	2.25	7.56	2.25	12.44	9.06	15.4
—	15	5.37	2.84	1.26	2.94	2.19	2.51	8.30	2.59	13.93	10.07	22.2
—	22	6.64	3.50	1.58	3.50	2.69	3.30	10.3	3.00	17.06	12.50	37.6

\* Working Load Limit applies only when the load is applied to the center of the saddle of the hook.

\*\* 3/4, 1, 1.1/2, and 2 Ton Carbon Steel Hooks also available in Hot Galvanized.

# ALLOY SWIVEL HOOKS

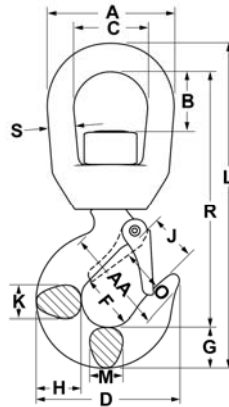

Size (WLL) (t) *	Dimensions in inches															Approximate Weight Each with Latch in Pounds
	A	B	C	D	F	G	H	J	K	L	M	O	R	S	AA	
1	2.00	0.82	1.25	2.86	1.25	0.73	0.81	0.93	0.63	2.66	0.63	0.89	4.55	0.38	1.50	0.75
2	3.00	1.50	1.75	3.59	1.50	1.00	1.16	1.06	0.88	7.75	0.88	1.00	6.12	0.63	2.00	2.25
3	3.00	1.50	1.75	4.00	1.62	1.13	1.31	1.19	0.94	8.25	0.94	1.09	6.50	0.63	2.00	2.30
5	3.50	1.64	2.00	4.84	2.00	1.44	1.63	1.50	1.31	9.69	1.13	1.36	7.50	0.75	2.50	4.96
7	4.56	2.29	2.50	6.28	2.50	1.81	2.06	1.78	1.66	12.47	1.44	1.61	9.63	1.00	3.00	10.29
11	5.00	2.53	2.75	7.54	3.00	2.25	2.63	2.41	1.88	14.75	1.63	2.08	11.37	1.13	4.00	19.40
15	5.62	2.48	3.12	8.34	3.25	2.59	2.94	2.62	2.19	16.40	1.94	2.27	12.25	1.25	4.00	23.25

\* Working Load Limit applies only when the load is applied to the center of the saddle of the hook.