



UPSON-WALTON™ SWAGE SOCKETS

Read important warnings and information in T.O.C. > **GENERAL WARNINGS** and **SWAGE SOCKETS** ⚠

Caution: When attaching swage sockets to wire rope it is extremely important to follow recommended procedures.

Swage sockets are recommended for use on 6 x 19 or 6 x 36 IWRC regular lay ropes. They are also satisfactory on galvanized bridge rope. They are **NOT** recommended for use on fiber core or lang lay ropes. Spheroidized annealed for cold swaging. Sockets properly applied have an efficiency rating of 100%. This rating is based on the catalog breaking strength of wire rope.

DOMESTIC

OPEN SWAGE SOCKETS A/S indicates the proper dimension of A after swaging.

Rope diameter in Inches	Dimensions in Inches										Approx. Weight Each in Pounds	A/S
	A	B	D	E	F	H	L	M	O	Y		
1/4"	.50	.27	.69	1.50	4.75	2.13	4.00	.31	.69	1.38	.55	.438
5/16"	.77	.34	.81	1.75	6.25	3.19	5.31	.41	.81	1.63	1.10	.688
3/8"	.77	.41	.81	1.75	6.25	3.19	5.31	.41	.81	1.63	1.08	.688
7/16"	.98	.48	1.00	2.00	7.81	4.25	6.69	.50	1.00	2.00	2.30	.875
1/2"	.98	.55	1.00	2.00	7.81	4.25	6.69	.50	1.00	2.00	2.25	.875
9/16"	1.26	.61	1.19	2.25	9.56	5.31	8.13	.63	1.25	2.50	4.60	1.125
5/8"	1.26	.67	1.19	2.25	9.56	5.31	8.13	.63	1.25	2.50	4.50	1.125
3/4"	1.55	.80	1.38	2.75	11.69	6.38	10.00	.75	1.50	3.00	7.80	1.375
7/8"	1.70	.94	1.63	3.25	13.63	7.44	11.63	.94	1.75	3.38	11.70	1.50
1"	1.98	1.06	2.00	3.75	15.63	8.50	13.38	1.03	2.00	4.00	17.80	1.75
1.1/8"	2.25	1.19	2.25	4.25	17.50	9.56	15.00	1.19	2.25	4.50	29.70	2.00
1.1/4"	2.53	1.33	2.50	4.75	19.44	10.63	16.50	1.19	2.50	5.00	36.00	2.25
1.3/8"	2.80	1.45	2.50	5.25	21.25	11.69	18.13	1.31	2.50	5.25	47.00	2.50
1.1/2"	3.08	1.58	2.75	5.75	23.25	12.75	19.75	1.44	3.00	5.75	65.00	2.75
1.3/4"	3.39	1.86	3.50	6.75	27.13	14.88	23.00	1.69	3.50	7.00	93.00	3.00
2"	3.94	2.11	3.75	8.00	31.44	17.00	26.75	1.81	4.00	8.00	145.00	3.50

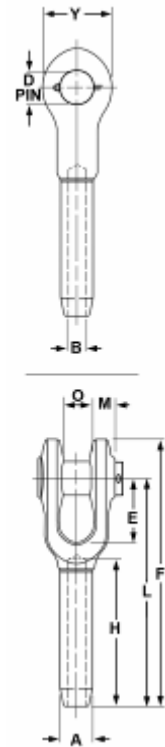

DOMESTIC

CLOSED SWAGE SOCKETS A/S indicates the proper dimension of A after swaging.

Rope diameter in Inches	Dimensions in Inches								Approx. Weight Each in Pounds	A/S
	A	B	C	D	E	H	K	L		
1/4"	.50	.27	1.44	.75	.50	2.13	4.38	3.50	.34	.438
5/16"	.77	.34	1.69	.88	.69	3.19	5.50	4.50	.79	.688
3/8"	.77	.41	1.69	.88	.69	3.19	5.50	4.50	.78	.688
7/16"	.98	.48	2.00	1.06	.88	4.25	6.94	5.75	1.45	.875
1/2"	.98	.55	2.00	1.06	.88	4.25	6.94	5.75	1.38	.875
9/16"	1.26	.61	2.50	1.25	1.13	5.31	8.75	7.25	2.78	1.125
5/8"	1.26	.67	2.50	1.25	1.13	5.31	8.75	7.25	2.75	1.125
3/4"	1.55	.80	3.00	1.44	1.31	6.38	10.38	8.63	5.00	1.375
7/8"	1.70	.94	3.50	1.69	1.50	7.44	12.13	10.13	7.50	1.50
1"	1.98	1.06	4.00	2.06	1.75	8.50	13.75	11.50	11.20	1.75
1.1/8"	2.25	1.19	4.50	2.31	2.00	9.56	15.25	12.75	15.80	2.00
1.1/4"	2.53	1.33	5.00	2.56	2.25	10.63	17.25	14.38	23.00	2.25
1.3/8"	2.80	1.45	5.50	2.81	2.50	11.69	18.88	15.75	31.00	2.50
1.1/2"	3.08	1.58	6.00	3.06	2.75	12.75	20.38	17.00	39.00	2.75
1.3/4"	3.39	1.86	6.75	3.56	3.00	14.88	24.00	20.00	52.00	3.00
2"	3.94	2.11	7.75	3.81	3.25	17.00	27.50	23.00	90.00	3.50

