

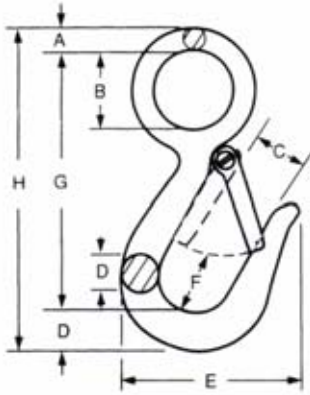

# HOOKS AND LINKS

**CAUTION: NEVER EXCEED THE WORKING LOAD LIMIT.**

Read important warnings and information in T.O.C. > GENERAL WARNINGS and HOOKS ⚠️



## BOAT HOOK – SNAP HOOK

Forged steel, hot galvanized. **DO NOT USE FOR OVERHEAD LIFTING.**

Size	Working Load Limit in Pounds	Weight Each in Pounds	Dimensions in Inches							
			A	B	C	D	E	F	G	H
7/16"	750	.42	.28	.68	.72	.58	2.05	.74	3.18	4.06
9/16"	1,000	.53	.34	1.12	.76	.55	2.16	.88	3.86	4.76

## CHAIN CONNECTING LINKS

**TO BE USED WITH PROOF COIL CHAIN ONLY. NOT TO BE USED FOR LIFTING.**

Forged steel, heat treated, electro galvanized.  
Meets the performance requirements of Federal Specification RR-C-271D, Type II.

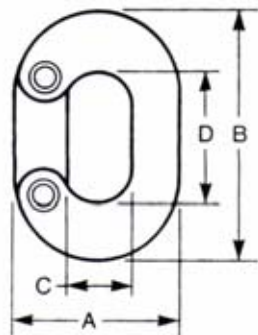

Size	Working Load Limit in Pounds	Approximate Weight Each in Pounds	Dimensions in Inches			
			A	B	C	D
3/16"	800	.03	.81	1.19	.31	.69
1/4"	1,300	.06	1.00	1.50	.44	.84
5/16"	1,900	.10	1.19	1.69	.47	.94
3/8"	2,650	.17	1.44	2.09	.56	1.19
1/2"	4,500	.36	1.75	2.63	.66	1.44

## RAPID LINKS, PLATED OR STAINLESS STEEL

**USE ONLY WITH CHAIN OF EQUAL OR LOWER WORKING LOAD LIMIT. NOT TO BE USED FOR LIFTING.**

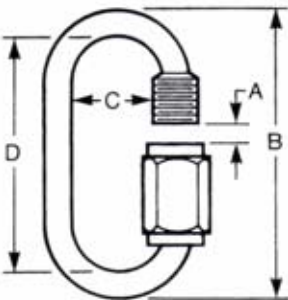

Size	Working Load Limit in Pounds		Approximate Weight Each in Pounds	Dimensions in Inches			
	Galv.	S.S.		A	B	C	D
1/8"	220	300	.02	.19	1.45	.39	1.19
3/16"	615	620	.05	.25	2.06	.50	1.69
1/4"	880	1,100	.08	.31	2.38	.56	1.88
5/16"	1,540	2,200	.18	.38	2.94	.69	2.31
3/8"	1,980	2,750	.23	.44	3.19	.69	2.44
1/2"	3,300	4,400	.52	.56	4.25	.94	3.25

## TWIN CLEVIS LINKS, GRADE 70

Forged steel, heat treated, plated.

**DO NOT USE FOR OVERHEAD LIFTING.**

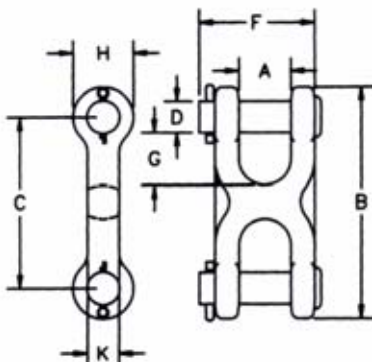

Chain Size in Inches	Working Load Limit in Pounds	Weight Each in pounds	Dimensions in Inches							
			A	B	C	D	F	G	H	K
1/4" – 5/16"	4,700	.31	.47	2.49	1.55	.38	1.32	.44	.935	.50
3/8"	6,600	.44	.53	2.81	1.81	.44	1.53	.50	1.00	.56
7/16" – 1/2"	11,300	.96	.65	3.62	2.31	.56	1.91	.63	1.31	.81