



CHAIN HOOKS

CAUTION: NEVER EXCEED THE WORKING LOAD LIMIT.
 Read important warnings and information in T.O.C. > GENERAL WARNINGS and HOOKS ⚠️.

HIGH TEST* CLEVIS GRAB HOOKS, GRADE 43

Forged steel, heat treated, plated.

DO NOT USE FOR OVERHEAD LIFTING

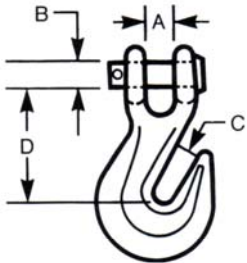

Size	Working Load Limit	Approximate Weight Each	Dimension in Inches			
	in Pounds	in Pounds	A	B	C	D
1/4"	2,600	0.43	0.38	0.38	0.34	1.94
5/16"	3,900	0.72	0.44	0.44	0.41	2.38
3/8"	5,400	1.15	0.56	0.47	0.50	2.63
1/2"	9,200	2.35	0.69	0.63	0.66	3.50
5/8"	13,000	4.10	0.81	0.63	0.81	4.19

Also available in DOMESTIC. * Ultimate Load is 3 times the Working Load Limit.

HIGH TEST* CLEVIS SLIP HOOKS, GRADE 43

Forged steel, heat treated, plated.

DO NOT USE FOR OVERHEAD LIFTING

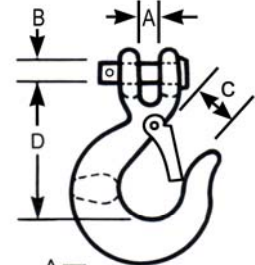

Size	Working Load Limit	Approximate Weight Each	Dimension in Inches			
	in Pounds	in Pounds	A	B	C	D
1/4"	2,600	0.58	0.38	0.38	0.88	2.56
5/16"	3,900	0.86	0.44	0.44	1.00	2.81
3/8"	5,400	1.40	0.56	0.47	1.28	3.25
1/2"	9,200	2.20	0.63	0.56	1.38	4.00

* Ultimate Load is 3 times the Working Load Limit.

HIGH TEST* EYE GRAB HOOKS, GRADE 43

Forged steel, heat treated, plated.

DO NOT USE FOR OVERHEAD LIFTING

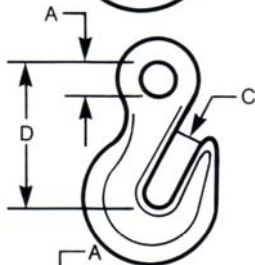

Size	Working Load Limit	Approximate Weight Each	Dimension in Inches			
	in Pounds	in Pounds	A	B	C	D
1/4"	2,600	0.30	0.50		0.31	1.88
5/16"	3,900	0.57	0.56		0.44	2.25
3/8"	5,400	0.95	0.69		0.50	2.56
1/2"	9,200	2.14	0.88		0.59	3.50

* Ultimate Load is 3 times the Working Load Limit.

HIGH TEST* EYE SLIP HOOKS, GRADE 43

Forged steel, heat treated, plated.

DO NOT USE FOR OVERHEAD LIFTING

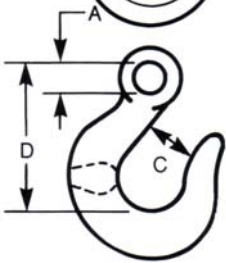

Size	Working Load Limit	Approximate Weight Each	Dimension in Inches			
	in Pounds	in Pounds	A	B	C	D
1/4"	2,600	0.36	0.50		0.69	2.00
5/16"	3,900	0.60	0.75		1.00	2.56
3/8"	5,400	0.91	0.75		1.06	3.00
1/2"	9,200	1.94	1.06		1.38	4.13

* Ultimate Load is 3 times the Working Load Limit.

ALLOY* CLEVIS GRAB HOOKS

Forged steel, heat treated, painted.

DO NOT USE FOR OVERHEAD LIFTING

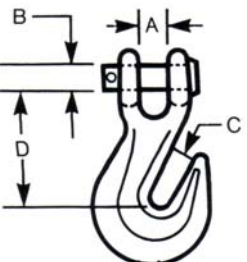

Size	Working Load Limit	Approximate Weight Each	Dimension in Inches			
	in Pounds	in Pounds	A	B	C	D
1/4"	3,500	0.43	0.38	0.38	0.34	1.94
5/16"	4,500	0.72	0.44	0.44	0.41	2.38
3/8"	7,100	1.15	0.56	0.47	0.50	2.63
1/2"	12,000	2.35	0.69	0.63	0.66	3.50

* Ultimate Load is 4 times the Working Load Limit.

ALLOY* CLEVIS SLIP HOOKS

Forged steel, heat treated, plated.

DO NOT USE FOR OVERHEAD LIFTING

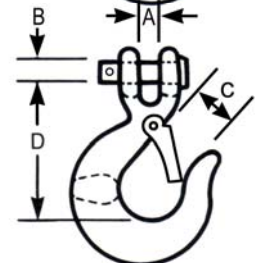

Size	Working Load Limit	Approximate Weight Each	Dimension in Inches			
	in Pounds	in Pounds	A	B	C	D
1/4"	2,750	0.58	0.38	0.38	0.88	2.56
5/16"	4,300	0.86	0.44	0.44	1.00	2.81
3/8"	5,250	1.40	0.56	0.47	1.28	3.25
1/2"	9,000	2.20	0.63	0.56	1.38	4.00

* Ultimate Load is 4 times the Working Load Limit.



EYE HOOKS

CAUTION: NEVER EXCEED THE WORKING LOAD LIMIT.

Read important warnings and information in T.O.C. > GENERAL WARNINGS and HOOKS ⚠️.

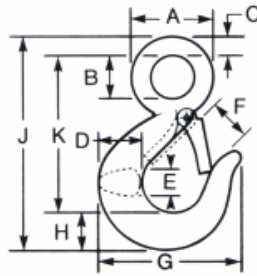

Carbon or Alloy steel, forged, heat-treated, painted, with latch installed or without.

Some sizes also available in DOMESTIC

Size (WLL)*		Dimensions in inches										Approximate Weight Each with Latch in Pounds
Carbon	Alloy	A	B	C	D	E	F	G	H	J	K	
**3/4 Ton	1 Ton	1.50	.75	.38	.88	.63	.94	2.88	.75	4.38	3.25	.6
**1	1.1/2	1.75	.88	.44	1.00	.69	1.06	3.13	.81	4.88	3.63	.82
**1.1/2	2	2.00	1.13	.44	1.19	.81	1.06	3.50	1.00	5.50	4.13	1.44
2	3	2.38	1.25	.59	1.38	.94	1.22	3.94	1.19	6.31	4.56	1.94
3	5	3.00	1.56	.69	1.63	1.19	1.50	5.00	1.50	7.94	5.75	3.94
5	7	3.81	2.00	.88	2.06	1.50	1.88	6.25	1.75	10.00	7.38	7.75
7.1/2	11	4.69	2.44	1.13	2.63	1.63	2.25	7.56	2.25	12.44	9.06	15.4
—	15	5.37	2.84	1.26	2.94	2.19	2.51	8.30	2.59	13.93	10.07	22.2
—	22	6.64	3.50	1.58	3.50	2.69	3.30	10.3	3.00	17.06	12.50	37.6

* Working Load Limit applies only when the load is applied to the center of the saddle of the hook.

** 3/4, 1, 1.1/2, and 2 Ton Carbon Steel Hooks also available in Hot Galvanized.

ALLOY SWIVEL HOOKS

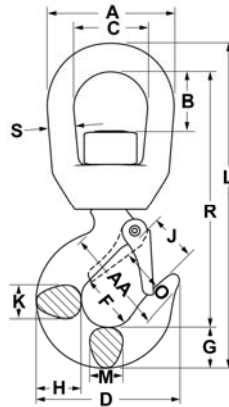

Size (WLL) (t) *	Dimensions in inches															Approximate Weight Each with Latch in Pounds
	A	B	C	D	F	G	H	J	K	L	M	O	R	S	AA	
1	2.00	0.82	1.25	2.86	1.25	0.73	0.81	0.93	0.63	2.66	0.63	0.89	4.55	0.38	1.50	0.75
2	3.00	1.50	1.75	3.59	1.50	1.00	1.16	1.06	0.88	7.75	0.88	1.00	6.12	0.63	2.00	2.25
3	3.00	1.50	1.75	4.00	1.62	1.13	1.31	1.19	0.94	8.25	0.94	1.09	6.50	0.63	2.00	2.30
5	3.50	1.64	2.00	4.84	2.00	1.44	1.63	1.50	1.31	9.69	1.13	1.36	7.50	0.75	2.50	4.96
7	4.56	2.29	2.50	6.28	2.50	1.81	2.06	1.78	1.66	12.47	1.44	1.61	9.63	1.00	3.00	10.29
11	5.00	2.53	2.75	7.54	3.00	2.25	2.63	2.41	1.88	14.75	1.63	2.08	11.37	1.13	4.00	19.40
15	5.62	2.48	3.12	8.34	3.25	2.59	2.94	2.62	2.19	16.40	1.94	2.27	12.25	1.25	4.00	23.25

* Working Load Limit applies only when the load is applied to the center of the saddle of the hook.



LATCH KITS / SORTING HOOKS

CAUTION: NEVER EXCEED THE WORKING LOAD LIMIT.

Read important warnings and information in T.O.C. > GENERAL WARNINGS and HOOKS ⚠️.

STAINLESS LATCH KITS

Hook Size		Approximate Weight Each in Pounds	Dimensions (in)			
Carbon	Alloy		A	B	C	D
3/4 Ton	1 Ton	.02	.44	.16	1.44	.59
1	1.1/2	.02	.44	.16	1.70	.59
1.1/2	2	.03	.45	.17	1.84	.77
2	3	.03	.47	.17	2.00	.82
3	5	.05	.56	.19	2.41	1.00
5	7	.09	.58	.20	2.97	1.21
7.1/2	11	.17	.59	.27	3.66	1.50
10	15	.25	.66	.27	3.69	1.52
—	22	.75	.78	.27	3.86	1.59

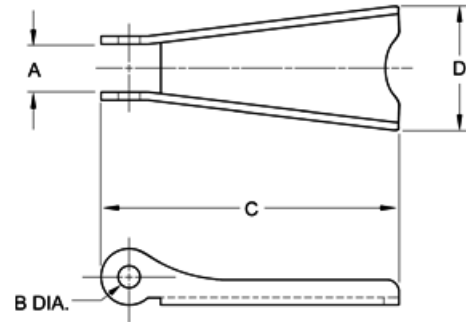

SORTING HOOK

CAUTION: NEVER EXCEED THE WORKING LOAD LIMIT.

Read important warnings and information in T.O.C. > GENERAL WARNINGS and HOOKS ⚠️.

Forged alloy steel, heat treated, painted.

Working Load Limit 2.1/2" from tip		2 Tons
Working Load Limit, at bottom		7.1/2 Tons
Approximate Weight Each		7.75 Pounds
Overall Length	L	9.69"
I.D. of Eye	A	1.38"
Opening at top of Hook	O	2.81"
Radius at Bottom of Hook	R	.63"

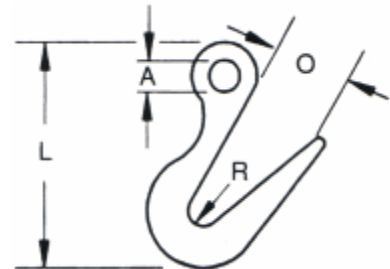



GRADE 80 ALLOY FITTINGS

CAUTION: NEVER EXCEED THE WORKING LOAD LIMIT.
Read important warnings and information in T.O.C. > GENERAL WARNINGS and LINKS ⚠️.

GRADE 80 COUPLING LINK

Forged alloy steel, heat treated. Meets the performance requirements of ASTM A952

Size	Working Load Limit in Pounds	Approximate Weight Each in Pounds	Dimensions in Inches				
			A	B	C	D	E
9/32"	3,500	.21	.33	1.93	.79	.79	.73
5/16"	4,400	.55	.37	2.75	1.02	.98	.89
3/8"	7,100	.77	.47	3.03	1.26	1.06	.98
1/2"	12,000	1.50	.61	3.34	1.38	1.26	1.18
5/8"	18,100	2.42	.73	4.05	1.69	1.53	1.42
3/4"	28,300	3.74	.90	4.56	1.89	1.85	1.73
7/8"	34,200	4.85	1.04	5.24	2.00	2.16	1.93
1"	47,700	9.26	1.24	5.83	2.36	2.60	2.36

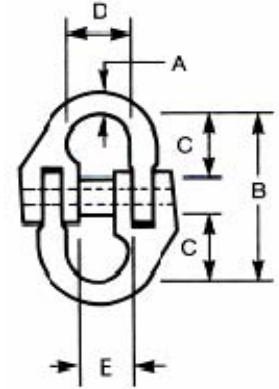

Sizes 9/32", 3/8" through 1.1/4" also available in DOMESTIC.

- To assemble:
1. Put two halves of coupling link together as shown.
 2. Put locking spacer between halves, line up with holes in coupling link.
 3. Drive pin through holes in coupling link and locking spacer until flush with outside of coupling link.

GRADE 80 CLEVIS GRAB HOOK, CRADLE TYPE

Forged alloy steel, heat treated. Painted. Meets the performance requirements of ASTM A952

Size	Working Load Limit in Pounds	Approximate Weight Each in Pounds	Dimensions in Inches				
			A	B	C	D	E
9/32-5/16"	4,500	.59	.35	.35	.39	1.97	1.18
3/8"	7,100	1.65	.51	.51	.51	2.83	1.73
1/2"	12,000	2.98	.67	.63	.67	3.46	2.06
5/8"	18,100	4.41	.83	.82	.79	4.01	2.52
3/4"	28,300	9.04	.94	.94	.94	4.60	3.34
7/8"	34,200	9.50	1.02	1.02	1.06	5.47	3.89

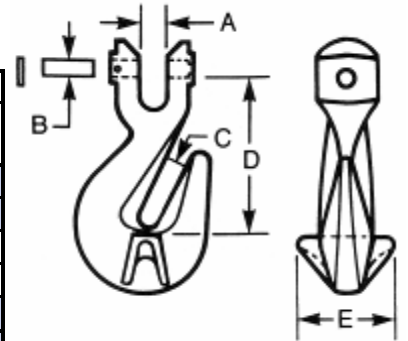

Sizes 9/32" through 3/4" also available in DOMESTIC

- To assemble:
1. Fully insert clevis pin.
 2. Secure clevis pin by driving locking pin into place until flush with body of hook.

GRADE 80 CLEVIS SLING HOOK

Forged alloy steel, heat treated. Painted. Meets the performance requirements of ASTM A952

Size	Working Load Limit in Pounds	Approximate Weight Each in Pounds	Dimensions in Inches			
			A	B	C	D
9/32-5/16"	4,500	1.19	.34	.35	1.00	3.40
3/8"	7,100	2.20	.48	.51	1.20	4.13
1/2"	12,000	4.07	.60	.63	1.61	5.06
5/8"	18,100	6.83	.75	.83	1.97	6.11
3/4"	28,300	12.12	.83	1.02	2.36	7.24
7/8"	34,200	13.50	.98	1.06	2.52	8.35

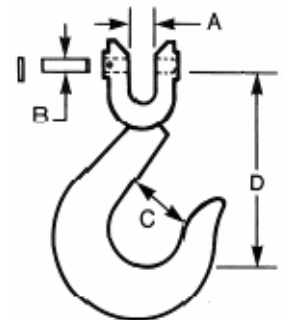

Sizes 9/32" through 3/4" also available in DOMESTIC

- To assemble:
1. Fully insert clevis pin.
 2. Secure clevis pin by driving locking pin into place until flush with body of hook.



IMPORTED and DOMESTIC LINKS

CAUTION: NEVER EXCEED THE WORKING LOAD LIMIT.
Read important warnings and information in T.O.C. > GENERAL WARNINGS and LINKS ⚠️.

GRADE 80 SUB ASSEMBLY, ALLOY

Grade 80 alloy, heat treated. Painted. Meets the performance requirements of ASTM A952

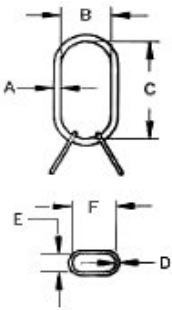

Dimensions in Inches								Approximate Weight Each in Pounds
Size	Chain Size	A	B	C	D	E	F	
3/4"	9/32"	.80	3.75	6.30	.50	2.36	4.33	4.7
1"	3/8"	1.05	4.33	7.50	.75	3.75	6.30	11.4
1.1/4"	1/2"	1.27	5.10	9.00	1.00	4.33	7.50	20.3
1.1/2"	5/8"	1.50	5.90	10.80	1.13	5.10	9.05	36.4
1.3/4"	3/4"	1.75	7.10	13.40	1.25	5.10	9.05	54.0
2"	7/8"	2.00	7.50	13.75	1.50	6.00	11.90	90.0
2.1/4"	1"	2.25	7.90	15.75	1.75	7.10	13.80	129.0

GRADE 80 ALLOY FITTINGS

CAUTION: NEVER EXCEED THE WORKING LOAD LIMIT.
Read important warnings and information in T.O.C. > GENERAL WARNINGS and LINKS ⚠️.

GRADE 80 SELF LOCKING CLEVIS HOOK

Grade 80 alloy, heat treated. Painted. Meets the performance requirements of ASTM A952

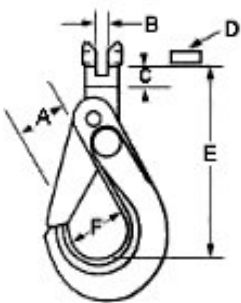

Dimensions in Inches								Approximate Weight Each in Pounds
Size	W.L.L. in lbs.	A	B	C	D	E	F	
9/32-5/16"	4,500	1.09	.34	.43	.35	3.72	1.42	1.2
3/8"	7100	1.50	.48	.55	.51	4.92	1.81	2.6
1/2"	12000	1.81	.60	.69	.63	6.18	2.36	5.0
5/8"	18100	2.24	.75	.77	.82	7.44	2.95	9.0

GRADE 80 SELF LOCKING EYE HOOK

Grade 80 alloy, heat treated. Painted. Meets the performance requirements of ASTM A952

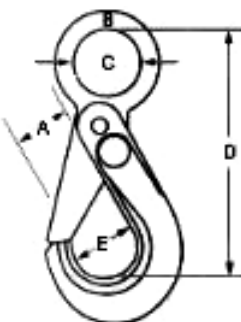

Dimensions in Inches							Approximate Weight Each in Pounds
Size	W.L.L. in lbs.	A	B	C	D	E	
9/32-5/16"	4,500	1.08	.39	1.02	4.43	1.42	1.2
3/8"	7,100	1.50	.51	1.30	5.94	1.81	2.5
1/2"	12,000	1.81	.63	1.65	7.28	2.36	4.9
5/8"	18,100	2.24	.71	2.05	9.05	2.95	8.8



HOOKS AND LINKS

CAUTION: NEVER EXCEED THE WORKING LOAD LIMIT.

Read important warnings and information in T.O.C. > GENERAL WARNINGS and HOOKS ⚠️

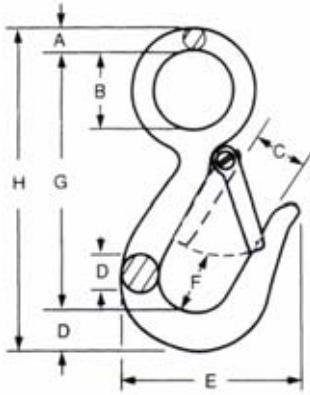

BOAT HOOK – SNAP HOOK

Forged steel, hot galvanized. **DO NOT USE FOR OVERHEAD LIFTING.**

Size	Working Load Limit in Pounds	Weight Each in Pounds	Dimensions in Inches							
			A	B	C	D	E	F	G	H
7/16"	750	.42	.28	.68	.72	.58	2.05	.74	3.18	4.06
9/16"	1,000	.53	.34	1.12	.76	.55	2.16	.88	3.86	4.76

CHAIN CONNECTING LINKS

TO BE USED WITH PROOF COIL CHAIN ONLY. NOT TO BE USED FOR LIFTING.

Forged steel, heat treated, electro galvanized.
Meets the performance requirements of Federal Specification RR-C-271D, Type II.

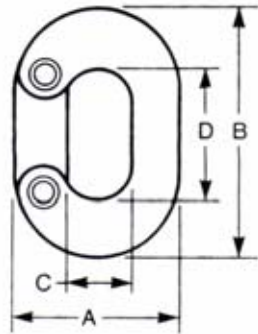

Size	Working Load Limit in Pounds	Approximate Weight Each in Pounds	Dimensions in Inches			
			A	B	C	D
3/16"	800	.03	.81	1.19	.31	.69
1/4"	1,300	.06	1.00	1.50	.44	.84
5/16"	1,900	.10	1.19	1.69	.47	.94
3/8"	2,650	.17	1.44	2.09	.56	1.19
1/2"	4,500	.36	1.75	2.63	.66	1.44

RAPID LINKS, PLATED OR STAINLESS STEEL

USE ONLY WITH CHAIN OF EQUAL OR LOWER WORKING LOAD LIMIT. NOT TO BE USED FOR LIFTING.

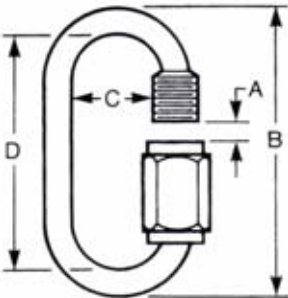

Size	Working Load Limit in Pounds		Approximate Weight Each in Pounds	Dimensions in Inches			
	Galv.	S.S.		A	B	C	D
1/8"	220	300	.02	.19	1.45	.39	1.19
3/16"	615	620	.05	.25	2.06	.50	1.69
1/4"	880	1,100	.08	.31	2.38	.56	1.88
5/16"	1,540	2,200	.18	.38	2.94	.69	2.31
3/8"	1,980	2,750	.23	.44	3.19	.69	2.44
1/2"	3,300	4,400	.52	.56	4.25	.94	3.25

TWIN CLEVIS LINKS, GRADE 70

Forged steel, heat treated, plated.

DO NOT USE FOR OVERHEAD LIFTING.

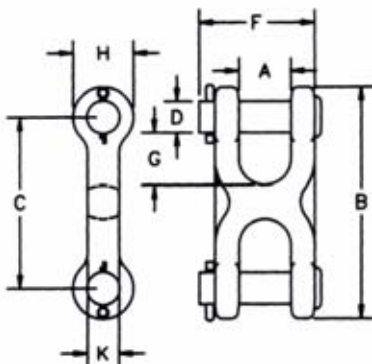

Chain Size in Inches	Working Load Limit in Pounds	Weight Each in pounds	Dimensions in Inches							
			A	B	C	D	F	G	H	K
1/4" – 5/16"	4,700	.31	.47	2.49	1.55	.38	1.32	.44	.935	.50
3/8"	6,600	.44	.53	2.81	1.81	.44	1.53	.50	1.00	.56
7/16" – 1/2"	11,300	.96	.65	3.62	2.31	.56	1.91	.63	1.31	.81



GRADE 100 ALLOY FITTINGS

CAUTION: NEVER EXCEED THE WORKING LOAD LIMIT.
Read important warnings and information in T.O.C. > GENERAL WARNINGS and LINKS ⚠️.

GRADE 100 COUPLING LINK

Forged alloy steel, heat treated. Meets the performance requirements of ASTM A952

Size	Working Load Limit in Pounds	Approximate Weight Each in Pounds	Dimensions in Inches				
			A	B	C	D	E
9/32"	4,300	0.31	0.41	2.05	0.79	0.75	0.63
5/16"	5,700	0.44	0.47	2.44	0.98	0.91	0.71
3/8"	8,800	0.77	0.47	2.76	1.18	1.06	0.91
1/2"	15,000	1.63	0.79	3.54	1.42	1.34	1.06
5/8"	22,600	2.56	0.87	4.13	1.57	1.54	1.30
3/4"	35,300	4.52	1.14	4.45	1.81	1.81	1.65
7/8"	42,700	6.83	1.18	5.24	2.17	2.28	1.93
1"	59,700*	14.99	1.57	7.56	3.35	3.25	2.24

* Not covered by ASTM A952

- To assemble:
1. Put two halves of coupling link together as shown.
 2. Put locking spacer between halves, line up with holes in coupling link.
 3. Drive pin through holes in coupling link and locking spacer until flush with outside of coupling link.

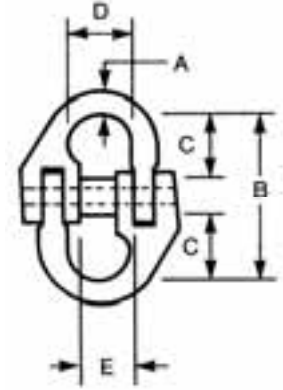

GRADE 100 CLEVIS GRAB HOOK, CRADLE TYPE

Forged alloy steel, heat treated. Painted. Meets the performance requirements of ASTM A952

Size	Working Load Limit in Pounds	Approximate Weight Each in Pounds	Dimensions in Inches				
			A	B	C	D	E
9/32"	4,300	0.97	0.39	0.35 x 0.89	0.39	2.58	1.18
5/16"	5,700	0.97	0.39	0.39 x 0.91	0.39	2.56	1.18
3/8"	8,800	2.12	0.51	0.51 x 1.24	0.51	3.15	1.34
1/2"	15,000	4.63	0.67	0.63 x 1.65	0.67	4.15	1.85
5/8"	22,600	7.50	0.75	0.83 x 2.03	0.75	4.40	2.52
3/4"	35,300	11.46	0.91	1.02 x 2.83	0.93	4.65	3.31
7/8"	42,700	18.72	1.03	1.02 x 2.83	1.08	5.88	3.47

- To assemble:
1. Fully insert clevis pin.
 2. Secure clevis pin by driving locking pin into place until flush with body of hook.

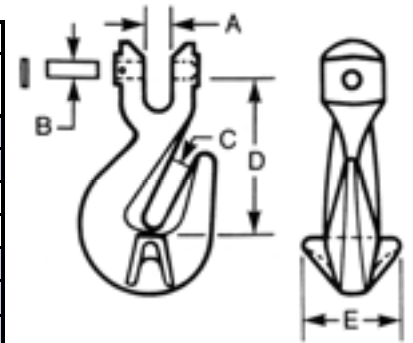

GRADE 100 CLEVIS SLING HOOK — WITH LATCH

Forged alloy steel, heat treated. Painted. Meets the performance requirements of ASTM A952

Size	Working Load Limit in Pounds	Approximate Weight Each in Pounds	Dimensions in Inches			
			A	B	C	D
9/32"	4,300	1.21	0.37	0.35 x 0.89	1.02	3.74
5/16"	5,700	1.10	0.37	0.39 x 0.89	1.02	3.74
3/8"	8,800	2.20	0.47	0.51 x 1.16	1.22	4.33
1/2"	15,000	3.75	0.59	0.63 x 1.46	1.57	5.35
5/8"	22,600	7.05	0.71	0.79 x 2.05	1.77	6.10
3/4"	35,300	11.02	0.91	0.94 x 2.87	2.09	7.28
7/8"	42,700	20.36	1.00	1.02 x 2.83	2.90	8.25

- To assemble:
1. Fully insert clevis pin.
 2. Secure clevis pin by driving locking pin into place until flush with body of hook.

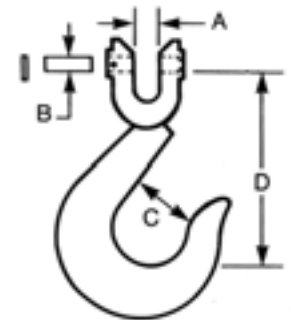



IMPORTED and DOMESTIC LINKS—GRADE 100

CAUTION: NEVER EXCEED THE WORKING LOAD LIMIT.
Read important warnings and information in T.O.C. > GENERAL WARNINGS and LINKS ⚠️.

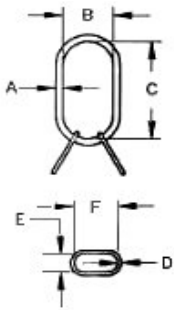

GRADE 100 SUB ASSEMBLY, ALLOY

Grade 100 alloy, heat treated. Painted. Meets the performance requirements of ASTM A952

Dimensions in Inches								Approximate Weight Each in Pounds
Size	Chain Size	A	B	C	D	E	F	
3/4"	9/32"	0.75	2.95	5.31	0.50	0.98	2.13	2.65
7/8"	5/16"	0.88	3.62	6.50	0.63	1.34	2.76	5.07
1"	3/8"	1.00	3.94	7.09	0.75	1.57	3.35	7.85
1.1/4"	1/2"	1.25	4.33	7.87	0.88	1.97	4.53	13.34
1.1/2"	5/8"	1.50	5.51	10.24	1.00	2.56	5.51	22.05

GRADE 100 ALLOY FITTINGS

CAUTION: NEVER EXCEED THE WORKING LOAD LIMIT.
Read important warnings and information in T.O.C. > GENERAL WARNINGS and LINKS ⚠️.

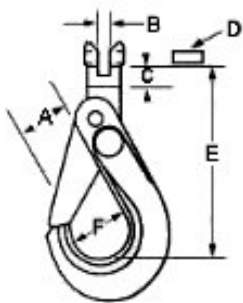

GRADE 100 SELF LOCKING CLEVIS HOOK

Grade 100 alloy, heat treated. Painted. Meets the performance requirements of ASTM A952

Dimensions in Inches								Approximate Weight Each in Pounds
Size	W.L.L. in lbs.	A	B	C	D	E	F	
9/32	4,300	1.34	0.35	0.39	0.35 x 0.89	4.84	1.69	2.09
5/16"	5,700	1.34	0.35	0.39	0.39 x 0.89	4.84	1.69	2.09
3/8"	8,800	1.77	0.47	0.55	0.51 x 1.24	5.63	2.20	3.53
1/2"	15,000	2.01	0.59	0.67	0.63 x 1.65	7.09	2.72	7.05
5/8"	22,600	2.36	0.75	0.75	0.82 x 2.03	8.46	3.15	13.23
3/4"	35,300	2.76	0.91	1.02	0.94 x 2.87	9.96	3.54	21.61

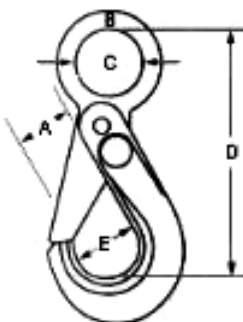

GRADE 100 SELF LOCKING EYE HOOK

Grade 100 alloy, heat treated. Painted. Meets the performance requirements of ASTM A952

Dimensions in Inches							Approximate Weight Each in Pounds
Size	W.L.L. in lbs.	A	B	C	D	E	
9/32-5/16"	5,700	1.34	0.47	0.98	5.31	1.69	2.12
3/8"	8,800	1.77	0.63	1.30	6.61	2.20	3.64
1/2"	15,000	2.01	0.79	1.57	8.07	2.72	7.16
5/8"	22,600	2.36	1.06	1.97	9.88	3.15	13.45
3/4"	35,300	2.76	1.18	2.36	11.42	3.54	21.61



CHAIN ASSEMBLIES

Read important warnings and information in T.O.C. > GENERAL WARNINGS and CHAIN ⚠️
**CAUTION: NEVER EXCEED THE WORKING LOAD LIMIT.
DO NOT FOR OVERHEAD LIFTING OR WHERE ITS FAILURE WILL CAUSE
DAMAGE TO PROPERTY OR LIFE.**

HIGH TEST BOOMER CHAIN (GRADE 43)

High Test chain with grab hook each end.



Size	Working Load Limit in Pounds	Approx. Wt. Each in Pounds
1/4" x 20 ft.	2,600	13.5
5/16" x 20 ft.	3,900	20.0
3/8" x 20 ft.	5,400	30.5

BINDING CHAIN (GRADE 70)

Transport chain with grab hook each end.



Size	Working Load Limit in Pounds	Approx. Wt. Each in Pounds
5/16" x 20 ft.	4,700	20.0
3/8" x 20 ft.	6,600	30.0

TAIL CHAIN (WINCH LINE END CHAIN) - DOMESTIC

Use same size chain as wire rope.



Wire Rope Diam.	Length	Working Load Limit in Pounds	Grade	No. of Links	Approx. Weight Each in Pounds
3/8"	18"	5,400	High Test	13	5
1/2"	18"	9,200	High Test	7	9
5/8"	18"	18,100	Alloy	8	10
3/4"	18"	28,300	Alloy	9	13
7/8"	24"	34,200	Alloy	9	24
1"	24"	38,750	Alloy	7	27

Proper end connection to wire rope should be maintained.

CLEVIS TYPE J HOOKS - DOMESTIC

Zinc Plated



Size	Working Load Limit in Pounds	Weight Each in Pounds
8"	3,000	2.03
15"	3,000	3.14