

ALLOY CHAIN FITTINGS, GRADE 100

CAUTION: NEVER EXCEED THE WORKING LOAD LIMIT.
 Read important warnings and information in T.O.C. > GENERAL WARNINGS and HOOKS .

COUPLING LINK, GRADE 100

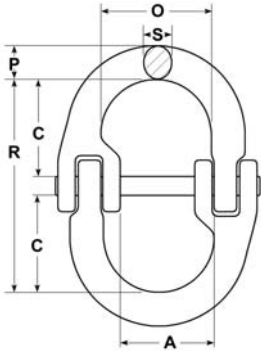

For Chain	Dimensions						Weight Ea. in Pounds	WLL in Pounds
	A	C	O	R	P	S		
9/32"	0.63	0.79	0.75	2.05	0.41	0.35	0.31	4,300
5/16"	0.71	0.98	0.91	2.44	0.47	0.37	0.44	5,700
3/8"	0.91	1.18	1.06	2.76	0.47	0.47	0.77	8,800
1/2"	1.06	1.42	1.34	3.54	0.79	0.67	1.63	15,000
5/8"	1.30	1.57	1.54	4.13	0.87	0.81	2.56	22,600
3/4"	1.65	1.81	1.81	4.45	1.14	0.98	4.52	35,300
7/8"	1.93	2.17	2.28	5.24	1.18	1.10	6.83	42,700
1"	2.24	3.35	3.25	7.56	1.57	1.18	14.99	59,700

OBLONG MASTER LINK, GRADE 100

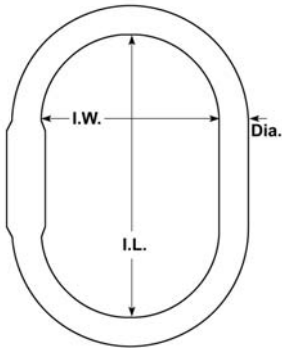

Trade Size	Dimensions			Weight Ea. in Pounds	WLL in Pounds	Suited for Chain Size	
	Dia.	I.L.	I.W.			1 Leg	2 Leg
1/2"	1/2"	4.33	2.36	0.75	6,000	9/32" & 5/16"	7/32"
5/8"	5/8"	4.33	2.36	1.17	8,600	5/16"	9/32"
3/4"	3/4"	5.31	2.95	1.76	12,900	3/8"	5/16"
7/8"	7/8"	6.50	3.62	3.31	17,600	1/2"	3/8"
1"	1"	7.09	3.94	5.07	30,000	5/8"	1/2"
1.1/4"	1.1/4"	7.87	4.33	8.60	39,100	3/4"	5/8"
1.1/2"	1.1/2"	10.24	5.51	14.00	61,100	7/8"	3/4"

SUB ASSEMBLY, GRADE 100

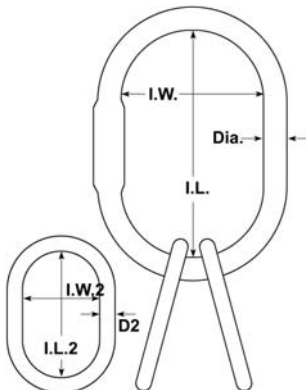

For Chain	Dimensions						Weight Ea. in Pounds	WLL in Pounds
	Dia.	I.L.	I.W.	D2	I.L.2	I.W.2		
9/32"	3/4"	5.31	2.95	1/2"	2.13	0.98	2.65	11,200
5/16"	7/8"	6.50	3.62	5/8"	2.76	1.34	5.07	15,200
3/8"	1"	7.09	3.94	3/4"	3.35	1.57	7.85	26,000
1/2"	1.1/4"	7.87	4.33	7/8"	4.53	1.97	13.34	39,000
5/8"	1.1/2"	10.24	5.51	1"	5.51	2.56	22.05	58,700